

**DESCRIPTION**

TRACE\*LITE's Nyte Forms series of LED luminaires is a versatile family of unique lighting fixtures that can be utilized to satisfy multiple application requirements, including wallpacks, floodlights, pole mounted area lights or inverted for use as a wall washer. All Nyte Forms luminaires are equipped with state of the art LED light engines that offer standard 0-10V dimming with excellent efficacies and lumen outputs. The superior thermal management maximizes the reliability and longevity that SSL systems can provide. The TLED-NFL series has an efficacy of 99 LPW with a delivered output of 7724 lumens. State of the art technology combined with application versatility and design consistency makes our new Nyte Forms family of luminaires the logical choice for any project. Unit is now available with emergency battery backup providing emergency lighting at approximately half the lumen output.

**SPECIFICATIONS**

**Construction:**

The TLED-NFL has a precision designed aluminum housing with stainless steel hardware, tempered glass lens, silicone gaskets and a UV resistant, thermoset polyester powder coated bronze finish. The TLED-NFL is completely sealed with silicone gaskets and is UL Listed for Wet Locations. The quick mount plate with built in bubble level allows for fast and easy installation. There is a knock-out in the top of the TLED-NFL housing to allow for the field installation of a photocontrol sensor. Thermal management is integral to the die-cast aluminum housing, with both the driver and the LED module each mounted directly to the housing in positions specifically designed to maximize heat dissipation and therefore increase the longevity reliability and performance of the TLED-NFL luminaire.

**Optics:**

The TLED-NFL series wallpack delivers exceptional light quality, with a standard correlated color temperature of 5000K with a CRI of  $\geq 70$  and an optional CCT of 4000K. The TLED-NFL LED light engine is fit with precision optical reflectors to distribute light forward and to the sides, producing an ideal wallpack distribution that maximizes fixture spacing while still delivering light where it is needed in the most efficient way possible. Producing 7724 delivered lumens, the TLED-NFL has an L70 of 100,000 hours.

**Electrical:**

The TLED-NFL includes 0-10V dimming as a standard option with LEDs powered by two constant current, high efficiency Class 2 LED drivers with active power factor correction (0.90 typical), a wet location rating, all around protection against over-voltage, over-temperature, short circuit conditions, and lightning. The TLED-NFL driver has a standard voltage sensing input of 120~277VAC 50/60Hz, 347VAC and 480VAC inputs are also available. It features a Class A EMI rating and complies with UL8750 safety regulations and with ANSI/IEEE C62.41 Class A Operation. The TLED-NFL is suitable for operation in -35°C to 50°C (-31°F to 122°F) ambient conditions.

**Thermal Management:**

The LED module and driver are mounted directly to the purpose designed housing which functions as a dedicated, LEDLITE<sup>logic</sup> thermal heat sink. The heat sink is unique and has been sized to maximize the thermal dissipation of the wallpack housing. This configuration optimizes the heat removal for the LEDs and the driver, which makes possible the high efficacy, lumen output and longevity of the TLED-NFL.

**Environmentally Friendly Design:**

TLED-NFL luminaires consume very little energy and provide long life in comparison to traditional lamp technologies. The TLED-NFL consumes only 78 watts, but the light output can be conservatively compared to a 250W HID luminaire of similar design. The TLED-NFL and provides a significant reduction in KW load and carbon emissions.

**Installation:**

The TLED-NFL series features a back plate design that can be easily mounted to any vertical surface, and is readily wired to a recessed J-box. An optional yoke mount, 2" slipfitter mount or 6" pole mount arm are also available for floodlighting and area lighting applications. Suitable for inverted mounting. Optional tamper-resistant hardware is available for applications where there is a high rate of vandalism, theft or in high traffic public spaces.

**Emergency Battery Backup (Option: BB):**

This option provides emergency powered illumination at full lumen output when the power goes out. Unit is complete with switchable AC operation for use as dusk to dawn with external photocontrol or use of a normally open switch. Following the return of normal utility power, the charging circuit will bring the battery pack to full recharge in 24 hours. A test switch is provided for testing and monitoring of unit performance. The BB option is rated for operation between -20°C and 40°C (-4°F and 104°F).

**Note:** 0-10V dimming is not available when BB option is selected.

Between -20°C and -10°C (-4°F and 14°F) battery backup runtime may be reduced by approximately 15%.

Model: \_\_\_\_\_ Date: \_\_\_\_\_  
 Accessories: \_\_\_\_\_  
 Job Name: \_\_\_\_\_ Type: \_\_\_\_\_

**Available While Supplies Last**



Specs at a Glance	
<b>Wattage (Nominal)</b>	76.75W
<b>Lumens (5000K)</b>	7724
<b>Efficacy (5000K)</b>	99
<b>CCT</b>	4000K or 5000K
<b>Input Voltage</b>	120~277 Voltage Sensing, 347VAC, 480VAC
<b>Optics</b>	Type II Very Short
<b>CRI</b>	$\geq 70$
<b>Certifications</b>	UL Listed for Wet Locations
<b>Warranty</b>	5 Years
<b>Ambient Temp</b>	-35°C to 50°C (-31°F to 122°F)

**Photocontrol (Accessory: PC):**

Optional field installed photocontrol provides dusk-to-dawn security. Input voltage must be specified to match the input voltage that will power the fixture.

**Testing & Compliance:**

The reliability and performance of the TLED-NFL is evaluated in accordance with the parameters outlined and reported by LM-79 and LM-80 documents. Photometric data is tested to IESNA LM-79-08 standard by an independent testing laboratory. Lumen maintenance, or L70, a measure of long term reliability, is determined for the light source, which consists of the LED and PSB sub-assembly as installed in the luminaire, using LM-80 in-situ thermal and reliability data as provided by the LED manufacturer in accordance with DOE/EPA standards.

**Listing:**

The TLED-NFL is UL certified under UL1598 specifications and is UL Listed for Wet Locations in all mounting configurations.

**Warranty:**

Up to 5 year warranty; see TRACE\*LITE Terms and Conditions for details.

## Fixture Performance

Part Number	Total System Watts	Initial Lumens	Lumens Per Watt (LPW)	L70 Hours @ 25°C	BUG Ratings
TLED-NFL-79	76.75W	7724	99	100,000	B3-U0-G0

NOTE: Lumen maintenance and life (part of LM-80 data) are per published information from primary LED suppliers and is based on design operation at their specified thermal management and electrical design parameters.

## Dimensions

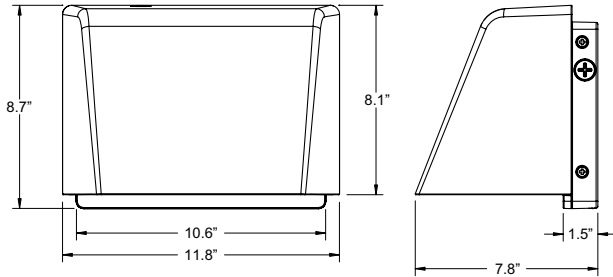

Approximate Weight: 15 lbs.

## Sample Photometrics

### TLED-NFL-79-VS-5K

IES: TYPE II VERY SHORT FULL CUTOFF

MOUNTING HEIGHT: 20 FEET

TILT: ZERO

HORIZONTAL SPACING CRITERIA: 1.36

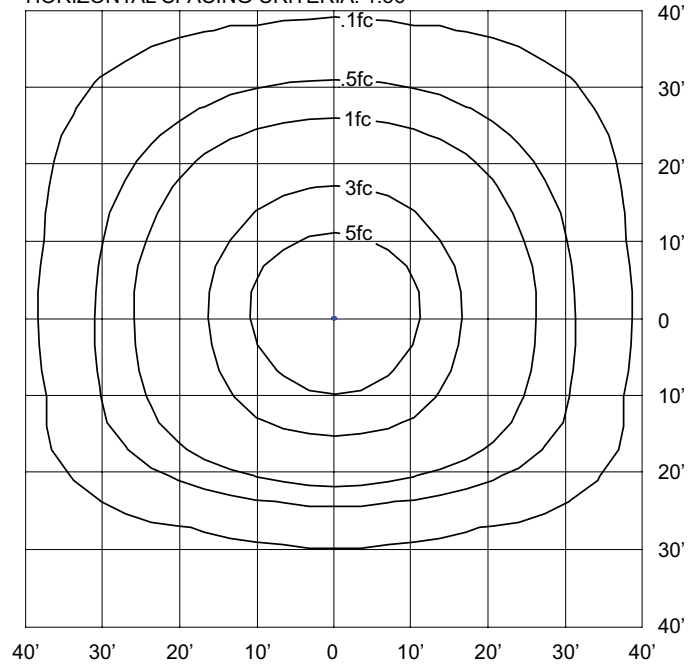

## Ordering Information

Example: TLED-NFL-79-VS-4K-BB

Series	Nominal Wattage	Input Voltage	CCT Temperature	Finish	Options (Factory Installed)
TLED-NFL	79 = 79 Watt	VS = 120~277VAC Voltage Sensing	5K <sup>1</sup> = 5000K	BLANK = Bronze (Std.)	BB <sup>2</sup> = Battery Backup

Notes	Accessories <sup>4</sup> (Field Installed)
<sup>1</sup> DLC qualified model	PCU <sup>3</sup> = 120-277VAC Photocontrol
<sup>2</sup> 0-10V dimming not available with BB option	SFE = 2" Slipfitter Mount
<sup>3</sup> Not available on units with BB option. Remote or external photocells are compatible. Consult factory for details.	EXM6-E = 6" Pole Mount Arm
<sup>4</sup> Order as separate line item	SWE = Yoke Mount

Specifications are subject to change without notice. Installation must be performed in accordance with Barron Lighting Group installation instructions.

10810302 REV 10