

**DESCRIPTION**

The second generation of the TLED canopy series features upgraded SSL light engines with more performance levels to choose from, a newly added housing design that is exclusive to TRACE\*LITE. The upgraded TLED-C maintains a low profile design, the TLED-RC is for recessed applications. All three housings are combined with our next generation high performance LED light engines featuring our superior thermal management that makes the entire family an attractive, energy saving choice. Constructed of die formed and welded aluminum, the TLED canopy series has been engineered to deliver optimum optical performance and lamp longevity. The attractive and durable housings have a UV resistant, powder coated finish to protect against the elements and are ETL Listed for Wet Locations. Our TLED series canopies incorporate contractor friendly features that allow for ease of installation in a variety of applications and allow them to be installed by a single person. Available with 5 different LED light engines configurations with 21, 28, 41, 55 or 72 total system watts and approximate delivered lumen outputs of 2004, 2936, 4210, 5391 or 7309 respectively. The TLED canopy series provide an energy saving solution to a wide spectrum of applications including, but not limited to security lighting in schools, office complexes, light commercial development, apartments, parking garages, entryways, and stairwells. The TLED canopy series are DesignLights Consortium™ (DLC) qualified and meet or exceed the efficacy requirements for various rebate programs across the country.

**SPECIFICATIONS**

**Construction:**

Precision die formed aluminum housings feature clean architectural lines with ample, integral mounting space for future accessories. The TLED canopy series most important construction feature is their integral thermal management. The housing is fabricated using 1/8" aluminum plate, which not only provides strength and durability but also acts as a substantial heat sink and allows for optimum performance and durability of the LED light engine without sacrificing design aesthetics or increasing the outside dimensions of the housing. LEDLITE<sup>logic</sup> heat sinking technology moves heat away from the LEDs by taking advantage of thermal convection dynamic properties and maximizing system performance that delivers up to a 190,000 hour life with 70% lumen maintenance. The TLED canopy series is ETL Listed for Wet Locations, and incorporates a UV resistant, long lasting, polyester based powder coat finish.

**Optics:**

The TLED canopy series of luminaires deliver exceptional light quality and efficiency with a performance optic design that provides excellent Type VS distribution. Our performance optic provides more lumens in the 30° to 60° zone, which satisfies the DLC requirements for fuel canopies. The stabilized optical PMMA lenses are specifically designed to distribute light where it is needed in the most efficient way possible making it the ideal luminaire for high efficiency applications.

**Electrical:**

A choice of five (5) performance levels are available in the TLED canopy series offering LED light engines with either 18, 24, 36, 48 or 64 LEDs, drawing 21, 28, 41, 55 or 72 total watts and providing approximately 2004, 2936, 4210, 5391 or 7309 initial delivered lumens, respectively. See chart on page 2 for complete performance figures. The available LED light engine wattages are powered by 0-10V dimmable, constant current control drivers and provide up to a 190,000 hour rated life with 70% lumen maintenance, a 4700K CCT, and a CRI of ≥72. All drivers are Class 2 power supplies with input voltage range of 120VAC to 277VAC, providing a Class A EMI rating and a high power factor of ≥0.90. The TLED series canopies are suitable for operation in -40°F to 104°F (-40°C to 40°C) ambient conditions.

**Thermal Management:**

LEDLITE<sup>logic</sup> heat sinking technology moves heat away from the LEDs by taking advantage of thermal convection dynamic properties and maximizing system performance that delivers up to a 190,000 hour life with 70% lumen maintenance.

**Installation:**

The TLED canopy series can be installed and wired by a single person. The base plate easily attaches to a 3" or 4" J-box, and the fixture housing is attached to the base plate by four (4) captive fasteners. The TLED-C can be surface mounted to a recessed J-box or pendant mounted using a standard 1/2" downrod & hardware (supplied by others). The TLED-RC can be recessed mounted.

**Battery Back-up (Option: BB):**

TRACE\*LITE's battery back-up option provides approximately 1400 lumens for 90 minutes in the event of a primary power failure. The battery back-up option includes a battery pack along with a charging/transfer device that keeps the battery pack charged during normal AC operation and transfers battery power to a portion of the LED modules when the device senses that the primary AC power has failed. Suitable for operation in 32°F to 104°F (0°C to 40°C) ambient conditions. Available on 24 LED version only.

**Transient Protection System (Option: TP):**

The LEDLITE<sup>logic</sup> optional transient protection device is designed to be used in conjunction with our LED drivers. The "-TP" option utilizes a 3-leaded device that protects Line-Ground, Line-Neutral, and Neutral-Ground in accordance with IEEE/ANSI C62.41.2 guidelines. The surge current rating of the "-TP" option is 10,000 amps.

Model: \_\_\_\_\_ Date: \_\_\_\_\_  
 Accessories: \_\_\_\_\_  
 Job Name: \_\_\_\_\_ Type: \_\_\_\_\_

Available While Supplies Last

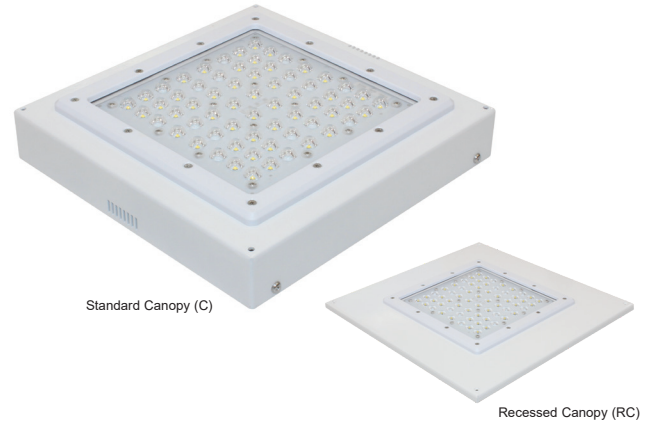

Specs at a Glance					
	18 LED	24 LED	36 LED	48 LED	64 LED
<b>Wattage (Nominal)</b>	21W	28W	41W	55W	72W
<b>Ingress Protection</b>	ETL Listed for Wet Locations				
<b>Lumens (lm)</b>	2004	2936	4210	5391	7309
<b>Efficacy (LPW)</b>	95	104	102	99	101
<b>CCT</b>	4700K				
<b>Input Voltage</b>	120-277 Voltage Sensing				
<b>Optics</b>	Performance Optic - Type V Very Short				
<b>CRI</b>	≥72				
<b>Warranty</b>	5 Years				
<b>Ambient Temp</b>	-40°F to 104°F (-40°C to 40°C)				

**Photocontrol (Option: PC):**

Optional field installed photocontrol provides dusk-till-dawn security. Input voltage must be specified to match fixture input voltage. Not available on recessed (TLED-RC) units.

**Testing & Compliance:**

The reliability and performance of the TLED series canopy luminaires are evaluated in accordance with the parameters outlined and reported by LM-79 and LM-80 documents. Photometric data is tested to IESNA LM-79-08 standard by an independent testing laboratory. Lumen maintenance, or L70, a measure of long term reliability, is determined for the light source, which consists of the LED and PSB sub-assembly as installed in the luminaire, using LM-80 in-situ thermal and reliability data as provided by the LED manufacturer in accordance with DOE/EPA standards. DesignLights Consortium® (DLC) qualified luminaire (check QPL for specific models).

**Listing:**

The TLED-C and TLED-RC are ETL certified under UL1598 specifications and listed for wet locations.

**Warranty:**

Any component that fails due to manufacturer's defect is guaranteed for 5 years. The warranty does not cover physical damage, abuse or acts of God. Manufacturer reserves the right to charge for such repairs if deemed necessary.

**Fixture Performance**

Part Number	Total System Watts	Initial Delivered Lumens	Lumens per Watt (LPW)	BUG Ratings
TLED-RC-18-VS-P	21	2004	95	B2-U0-G1
TLED-RC-24-VS-P	28	2936	104	B2-U0-G1
TLED-RC-36-VS-P	41	4210	102	B3-U0-G1
TLED-RC-48-VS-P	55	5391	99	B3-U0-G1
TLED-RC-64-VS-P	72	7309	101	B3-U0-G1

NOTE: Lumen maintenance and life (part of LM-80 data) are per published information from primary LED suppliers and is based on design operation at their specified thermal management and electrical design parameters.

**Dimensions**

**SURFACE STANDARD**

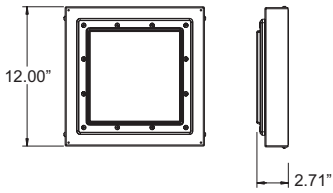

**RECESSED**

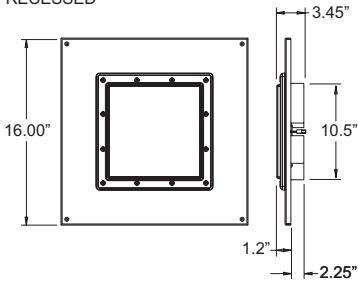

Approximate Weight: 14 lbs.

**Sample Photometrics**

TLED-C-48-VS-P Mounted at 10' (Type V Very Short)  
Horizontal Spacing Criteria: 1.80

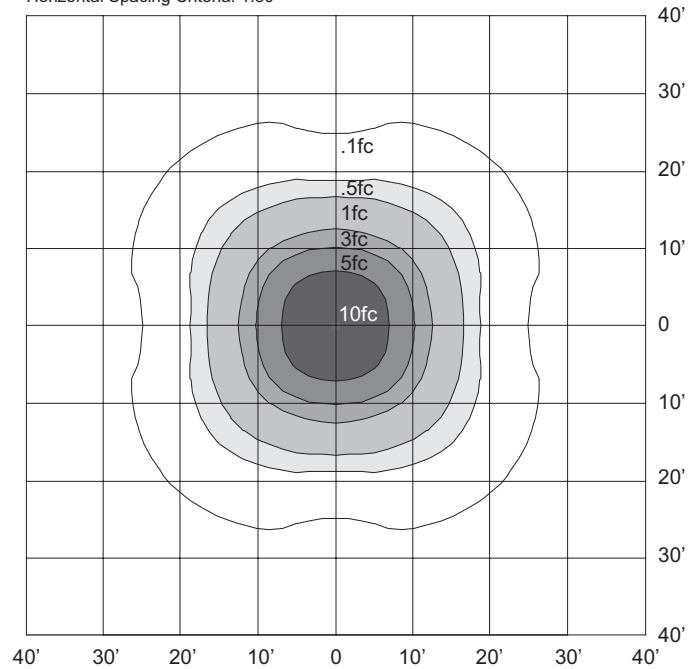

**Ordering Information**

**Example:** TLED-C-24-VS-P-WW

Series	# of LEDs	Input Voltage	Optics	Finish (Housing/Trim)	Options (Factory Installed)
TLED-C = Standard Canopy	18 = 18 LEDs	VS = 120~277VAC (Voltage Sensing)	P = Performance Optics	WW = White/White	BB <sup>1</sup> = Battery Back-up (24 LED version only)
TLED-RC = Recessed Canopy	24 = 24 LEDs				TP = Transient Protection System
	36 = 36 LEDs				CC <sup>3</sup> = Custom Color
	48 = 48 LEDs				
	64 = 64 LEDs				

**Notes**

<sup>1</sup> 120V and 277V operation, 0-10V dimming not available, not ETL listed and only available with TLED-C-24-VS-G/P-WW model. Consult factory for details.

<sup>2</sup> Not available on recessed (TLED-RC) units

**Accessories<sup>4</sup>** (Field Installed)

<sup>3</sup> Consult factory for specific part number and details

PCU<sup>2</sup> = 120-277VAC Photocontrol

<sup>4</sup> Order as separate line item

TLED-C-CP-WW = Canopy Trim Kit (for mounting to surface mount junction box)

Specifications are subject to change without notice. Installation must be performed in accordance with Barron Lighting Group installation instructions.

10810264 REV6 02/19