

DESCRIPTION

The high-performance LASP LED center basket luminaire is available in 2' x 2' and 2' x 4' sizes and offers up to 140 LPW to maximize energy savings and utility rebates. The LASP is designed to deliver general ambient lighting in a variety of indoor settings, including schools, offices, hospitals and stores, and is the perfect choice for both new construction and retrofits. This high-efficacy luminaire provides long-life, uniform illumination, standard 0-10VDC dimming capability as well as egress lighting, thus making it the ideal choice for your troffer lighting needs.

CONSTRUCTION

- Steel housing in a white finish
- LED light engine is protected by a diffused polycarbonate lens
- Enclosure fits in standard 2' x 2' (LASP22) or 2' x 4' (LASP24) grid ceilings
- Standard earthquake clips provide secure installation in grid ceilings

OPTICS/LEDS

- Available in 3500K, 4000K and 5000K CCT
- Polycarbonate lens provides uniform illumination with no visible LED pixilation
- Efficacies up to 140 LPW maximize energy savings and utility rebates
- L70 of 100,000 hours
- CRI of ≥80

ELECTRICAL

- 120-277VAC, 50/60Hz
- 1-10V Dimming driver
- Power factor > 0.90
- Total harmonic distortion < 20%

INSTALLATION

- Easy installation in new construction or retrofit applications, fits in standard 2' x 2' or 2' x 4' grid ceilings
- Standard mounting options include recessed mounting in grid ceiling or suspension mount using attached hanging brackets

ACCESSORIES

- Field-installable battery packs available for emergency egress (LBD-xx)
- Surface mount kit allows for installation on plaster or other hard ceilings (LPxx-SMK)
- Cable mount kit (3') allows fixture to be suspended. Includes 6 x 3' cable suitable to mount one unit (LP-CMK)

TESTING & COMPLIANCE

- cUL Listed for Damp Locations and IC rated (insulated ceilings)
- Operating temperatures: -20°C to 40°C (-4°F to 104°F)

WARRANTY

- Five year warranty (Terms and Conditions apply)

Model: _____ Date: _____
 Accessories: _____
 Job Name: _____ Type: _____

AVAILABLE WHILE SUPPLIES LAST



Specs At A Glance*						
Wattage (W)	32			40		
Model	LASP22 (2' X 2')			LASP24 (2' X 4')		
CCT	3500	4000	5000	3500	4000	5000
Lumens (lm)	4293	4371	4527	5743	5793	5894
Efficacy (LPW)	136	138	140	130	132	134
CRI	≥80					
Input Voltage	120 - 277VAC, 50/60Hz					
Certifications	UL Listed for Damp Locations, IC Rated					
Warranty	5 Years					
Operating Temp	-20°C to 40°C (-4°F to 104°F)					
Weight	6.2 lbs			12.8 lbs		

*Nominal Wattage, tested at 5000K CCT

Note: Environment and application will affect actual performance. Typical values and 25°C (77°F) used for testing. Specifications subject to change without notice.

ORDERING INFORMATION

Example: LASP22-32-35K

Series/Wattage	CCT	Accessories ² (Field Installed)
LASP22-32 ¹ = 2' X 2' Premium Basket, 32 Watts	35K = 3500K	LBD-5-NC-CW-C ³ = 5 Watt Battery Pack for Emergency Egress
LASP24-40 ¹ = 2' X 4' Premium Basket, 40 Watts	4K = 4000K	LBD-7-NC-CW-C ³ = 7 Watt Battery Pack for Emergency Egress
	5K = 5000K	LBD-10-NC-CW-C ³ = 10 Watt Battery Pack for Emergency Egress
		LBD-13-NC-CW-C ³ = 13 Watt Battery Pack for Emergency Egress
		LBD-17-NC-CW-C ³ = 17 Watt Battery Pack for Emergency Egress
Notes:		LP-CMK = Cable Mount Kit (6 pieces X 3')
¹ Packaged two (2) per carton		LP22-SMK ⁴ = 2' X 2' Surface Mount Kit
² Order as a separate line item; shipped in a separate box for field installation		LP24-SMK ⁴ = 2' X 4' Surface Mount Kit
³ LBD is not IC Rated. Consult the LBD spec sheet for more information		
⁴ LBD accessory not compatible with Surface Mount Kit (LPxx-SMK)		

SAMPLE PHOTOMETRICS

LASP22-32-4K

IES: TYPE VS Very Short
 MOUNTING HEIGHT: 10'
 TILT: ZERO

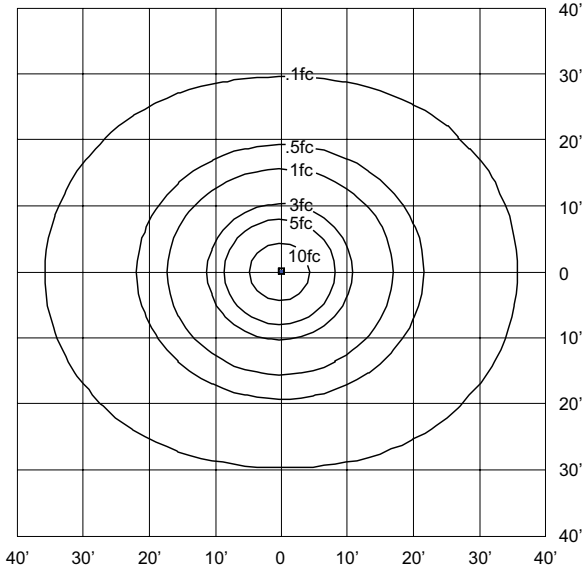

DIMENSIONS

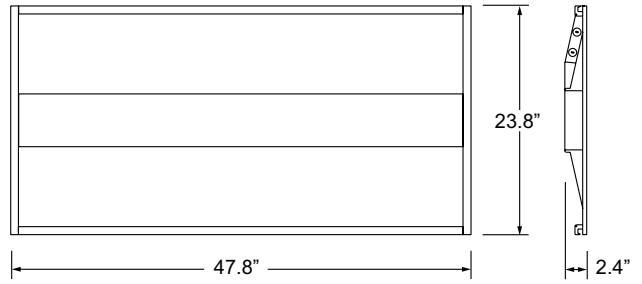
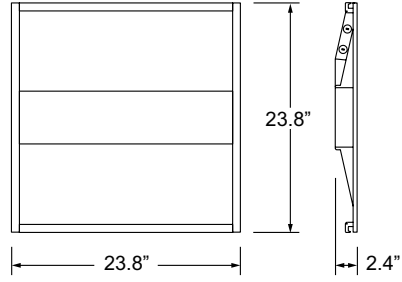

LUMEN OUTPUT SUMMARY FOR LBD BATTERY PACK ACCESSORY

LASP BATTERY PACKS:			LBD-5-NC-CW-C	LBD-7-NC-CW-C	LBD-10-NC-CW-C	LBD-13-NC-CW-C	LBD-17-NC-CW-C
Model	Unit Lumens	Unit Wattage	Battery Backup Lumens				
LASP22-32-35K	4293	32	591	828	1183	1538	2011
LASP22-32-4K	4371	32	600	840	1200	1560	2041
LASP22-32-5K	4527	32	609	852	1218	1583	2070
LASP24-40-35K	5743	40	565	791	1131	1470	1922
LASP24-40-4K	5793	40	574	803	1148	1492	1952
LASP24-40-5K	5894	40	582	816	1165	1515	1981

Specifications are subject to change without notice.
 Installation must be performed in accordance with
 Barron Lighting Group installation instructions.

10810372 Rev 6