

DESCRIPTION

The BL350 Series 3.5" LED dedicated IC housing is available for new construction and remodel applications and is suitable for direct contact with insulation. Air-tight construction reduces energy costs by reducing the amount of air leakage through the ceiling.

SPECIFICATIONS

Remodel:

- Four remodel clips secure housing and accommodates 1/2" and 5/8" ceiling materials
- Housing adjusts from 5/8" to 1 3/8" to accommodate various ceiling thicknesses
- Galvanized steel construction

New Construction:

- Galvanized steel construction with removable housing for easy access to the junction box
- Pre-installed nails in bar hangers easily install in regular and engineered lumber joints
- Adjustable bar hangers from 13 5/8" – 25" and can be repositioned 90° on plaster frame

Installation:

- Contains seven (7) 1/2" knockouts
- Features 2-pin quick connector

Testing & Compliance:

- IC Rated
- UL listed for Damp Locations
- Certified under ASTM-E283 for air-tight construction
- Meets state of California Title 24 Requirements (when used with compliant downlight)

Warranty:

- Five year warranty (terms and conditions apply)

Model: _____ Date: _____
Accessories: _____
Job Name: _____ Type: _____



ORDERING INFORMATION Example: BL350ICATLEDNND-QN

Model	Description
BL350ICATLEDNND-QN	3.5" Dedicated IC LED Housing for New Construction Applications
BL350ICATLEDRND-Q	3.5" Dedicated IC LED Housing for Remodel Applications

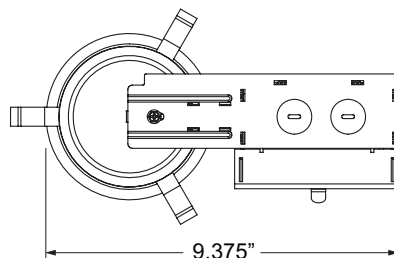
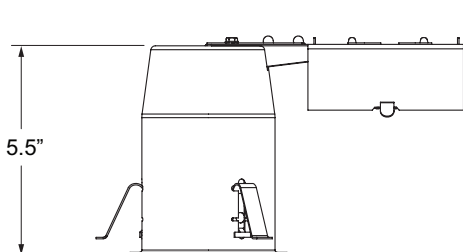
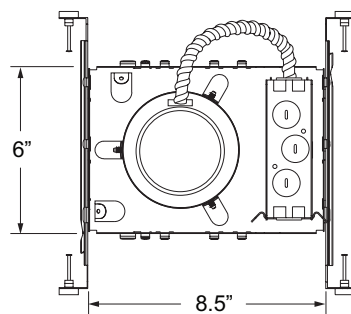
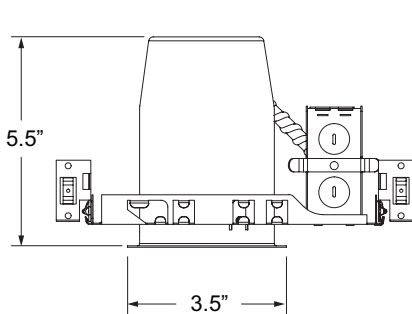

Model	Weight
BL350ICATLEDNND-QN	1.20 lbs
BL350ICATLEDRND-Q	1.06 lbs

Specifications are subject to change without notice. Installation must be performed in accordance with Barron Lighting Group installation instructions.